

Gemino - selection guide

Choose the Gemino rollator that suits you 100%

GEMINO



GEMINO 20

Light-weight design rollator. Great functionality at an attractive price

Indoor and outdoor use

Everyday use

150 kg
130 kg (M)
125 kg (S)

150-200 cm
135-170 cm (M)
125-165 cm (S)
Also suitable for children



GEMINO 30

Our original 100% rollator. Award-winning design combining high indoor maneuverability with outdoor performance. Lots of colour options and accessories for easy customization

Use indoors and out, mainly in the city

Everyday use

150 kg
130 kg (M)
125 kg (S)

150-200 cm
135-170 cm (M)
125-165 cm (S)
Also suitable for children

Small turning radius for great indoor manoeuvrability

Easy personalization with frame colours and bag colours. Wide range of accessories



GEMINO 60

Designed for any kind of terrain and heavy-duty use. Lightweight, yet rock-solid. All the benefits of the award-winning Gemino 30 and more

Mostly outdoor use, also on rugged terrain, occasionally indoors

Active / heavy-duty use

150 kg
150 kg (M)

150-200 cm
135-170 cm (M)

Extra wide and long frame for ultimate stability

Extra-large and soft wheels ensure ultimate comfort and easy negotiation of any obstacle

Extra wide seat



GEMINO 30 walker

Lightweight walker with adjustable forearm supports. The perfect companion if you need extra support and stability indoors. Also great for gait training.

Indoor use
Everyday use / gait training

150 kg
130 kg (M)

150-200 cm
135-170 cm (M)

Height-adjustable forearm supports for extra support and stability



GEMINO 60 walker

Optimal support and stability – indoors and out. Combines the comfortable rolling characteristics and stability of the Gemino 60 with the additional support and safety you'd expect from a walker.

Indoor and outdoor use, also on uneven terrain
Everyday use / gait training

130 kg
130 kg (M)

150-200 cm
135-170 cm (M)

Height-adjustable forearm supports for extra support and stability

Extra wide and long frame for ultimate stability

Extra-large and soft wheels ensure ultimate comfort and easy negotiation of any obstacle

Extra strong bag (10 kg load capacity)



GEMINO 30 SpeedControl

For extra security the brakes in the rear wheels will automatically come into action in case of sudden acceleration. Great for gait training

Use indoors and out, mainly in the city

Everyday use

100 kg

150-200 cm
135-170 cm (M)
125-165 cm (S)
Also suitable for children

Small turning radius for great indoor manoeuvrability

In case of sudden acceleration, the SpeedControl wheels will automatically give resistance



GEMINO 30 parkinson

Specially designed for people with Parkinson's. Featuring a slowdown brake promoting a steady pace, and a reverse braking system and laser light to help with 'freezing'.

Use indoors and out, mainly in the city

Everyday use

130 kg
130 kg (M)

150-200 cm
135-170 cm (M)

Small turning radius for great indoor manoeuvrability

Reverse braking system: the rollator immediately stops moving once the brake is released

Slowdown brake provides extra resistance and promotes a steady pace

Laser light can be activated to help overcome 'freezing'

Gemino range - specifications

GEMINO

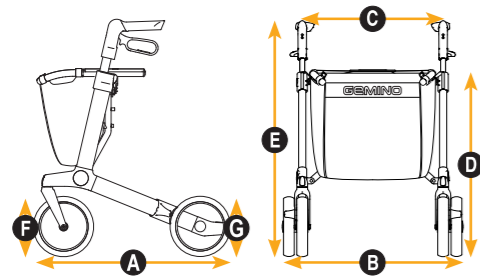

		GEMINO 20			GEMINO 30			GEMINO 60		GEMINO 30walker		GEMINO 60walker		GEMINO 30 SpeedControl			GEMINO 30 parkinson	
		20	20M	20S	30	30M	30S	60	60M	30	30M	60	60M	30	30M	30S	30	30M
DIMENSIONS																		
Maximum user weight	kg	150	130	125	150	130	125	150	150	150	130	130	130	100	100	100	130	130
Recommended user height	cm	150-200	135-170	125-165	150-200	135-170	125-165	150-200	135-170	150-200	135-170	150-200	135-170	150-200	135-170	125-165	150-200	135-170
Maximum load capacity in basket	kg	5	5	5	5	5	5	10	10	5	5	10	10	5	5	5	5	5
Total length A	cm	65	65	68	65	65	68	74	74	65	65	74	74	65	65	68	65	65
Total width B	cm	60	60	55	60	60	55	64	64	61	61	64	64	60	60	55	60	60
Total weight without basket (with basket)	kg	7.1 (7.3)	7.0 (7.2)	6.6 (6.8)	7.1 (7.4)	7.0 (7.3)	6.6 (6.8)	8.5 (8.8)	8.2 (8.5)	10.6 (10.9)	10.4 (10.7)	11.8 (12.1)	11.6 (11.9)	8.7 (8.9)	8.6 (8.8)	8.2 (8.4)	7.5 (7.8)	7.4 (7.7)
Width between centre of push handles C	cm	47	47	42	47	47	42	51	51	25.5	25.5	32	32	47	47	42	47	47
Seat height D	cm	62	55	48	62	55	48	62	53	62	55	62	53	62	55	48	62	55
Total height E	cm	78 - 100	69 - 88	65 - 77	78 - 100	69 - 88	65 - 77	76-95	73 - 83	98 - 111.5	84 - 100	98.5 - 115.5	89.5 - 98.5	78 - 100	69 - 88	65 - 77	78 - 100	69 - 88
Total height folded	cm	80	76	69	80	76	69	84	80	97	89	109	101	80	76	69	80	76
Total length folded	cm	65	65	68	65	65	68	74	74	65	65	74	74	65	65	68	65	65
Total width folded	cm	23	23	23	23	23	23	23	23	35.5	35.5	35.5	35.5	23	23	23	23	23
Diameter front wheels F	cm	20 x 3.6	20 x 3.6	20 x 3.6	20 x 3.6	20 x 3.6	20 x 3.6	28 x 4.2	28 x 4.2	20 x 3.6	20 x 3.6	28 x 4.2	28 x 4.2	20 x 3.6	20 x 3.6	20 x 3.6	20 x 3.6	20 x 3.6
Diameter rear wheels G	cm	20 x 3.6	20 x 3.6	20 x 3.6	20 x 3.6	20 x 3.6	20 x 3.6	23 x 4.2	23 x 4.2	20 x 3.6	20 x 3.6	23 x 4.2	23 x 4.2	20 x 3.6	20 x 3.6	20 x 3.6	20 x 3.6	20 x 3.6
PERFORMANCE																		
Turning radius	cm	84	84	79	84	84	79	95	95	84	84	95	95	84	84	79	84	84
COLOUR OPTIONS																		
Grey		✓	✓	✓														
Silver grey					✓	✓	✓	✓	✓	✓	✓	✓	✓	✓	✓	✓	✓	✓
Champagne					✓	✓												
Midnight blue					✓	✓	✓									✓		
Pink					✓		✓									✓		
Apple green					✓	✓												
Black					✓													
CERTIFICATES																		
CE		✓	✓	✓	✓	✓	✓	✓	✓	✓	✓	✓	✓	✓	✓	✓	✓	✓
EN 12182		✓	✓	✓	✓	✓	✓	✓	✓	✓	✓	✓	✓	✓	✓	✓	✓	✓
ISO 11199-2		✓	✓	✓	✓	✓	✓	✓	✓					✓	✓	✓	✓	✓
ISO 11199-3										✓	✓	✓	✓					

CE Gemino Walker rollators: EN 12182, ISO 11199-3 - All other Gemino rollators: EN 12182, ISO 11199-2

For further information on the full specification, options and accessories, please refer to the order form. All information is subject to change without notification. Please consult Sunrise Medical with any queries you may have.